



PRO TRACK LAND INDUSTRIAL PARK

Space to Grow, Strength to Lead

www.protrackgroup.com



3 STOREY SEMI-D FACTORIES

KEY FEATURES

5 STARS



HUGE ENTRANCE



STRATEGIC
LOCATION

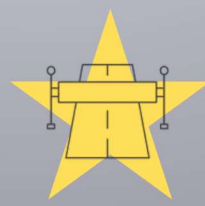

EASY ACCESS
TO HIGHWAY



MATURE
INDUSTRIAL
AREA



**FREEHOLD
LAND**



PRO TRACK LAND SDN. BHD.

(1576147-M)



CRAFTED WITH INTENTION, OUR DESIGN UNLOCKS ENDLESS CONFIGURATION POSSIBILITIES—PERFECTLY SUITED FOR DIVERSE BUSINESS SETUPS AND LIGHT TO MEDIUM INDUSTRIES—MAXIMISING SPACE AND ENHANCING OPERATIONAL FLOW.



MASTER PLAN

WE ARE HERE



PRO TRACK LAND INDUSTRIAL PARK

- Location : Jalan Bangi Lama, Semenyih
- Land Title : Industrial
- Land Tenure : Freehold
- Mukim : Semenyih
- District : Hulu Langat
- State : Selangor

SEMI-D FACTORY

---LOT DIMENSION---

TYPE A=80' x 181'

TYPE B=77' x 183'

---BUILT UP AREA---

14,400 SQFT

13,800 SQFT

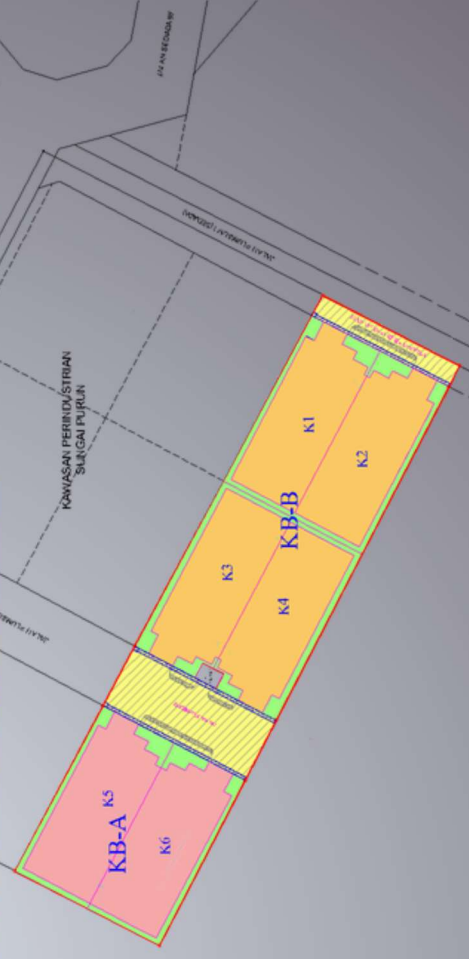

Production Area

Floor Loading 15kN/m²
Ceiling Height 8.3m

Warehouse

Floor Loading 5kN/m²

Office



Floor Height 13.5m

FLOOR PLANS

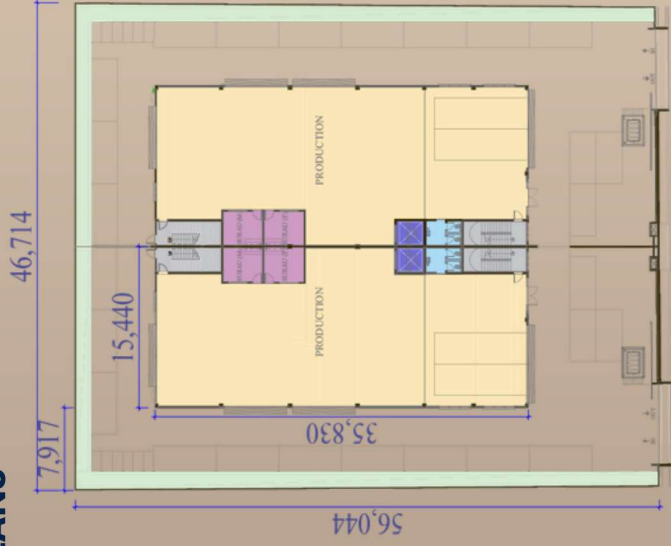

GROUND FLOOR

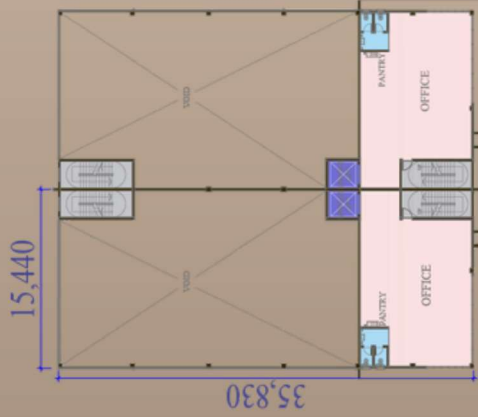

FIRST FLOOR

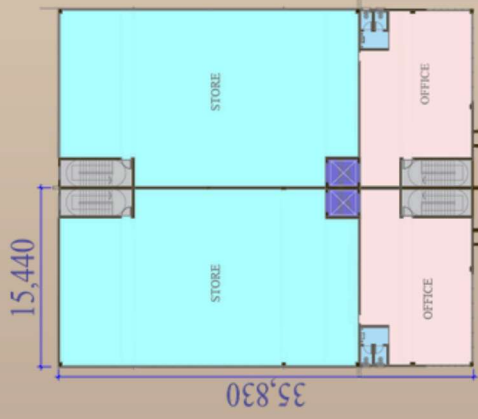

SECOND FLOOR

3 STOREY SEMI-D FACTORIES

24m x 56m

77' x 183'

VERSATILITY

Total Build -up Area
13,800. SQFT

Power Supply
150 Amp

Ground Floor Area (GFA)
5,955. SQFT

Automatic Roller Shutter
4 Units

Floor Loading from
15kN/m²

ELEVATOR
2 WAYS OPENING
C/W 1.5 TON



Strategic Location



SCHEDULE YOUR APPOINTMENT

Mondays to Fridays : 9am to 6pm
 Weekends and Public Holidays: 10am to 5pm (by appointment)

VISIT OUR SALE GALLERY



PRO TRACK LAND SDN BHD
 20401030298 (1576147-M)
 No. B-1-10 & 11, Tulin 28, Jalan Riang Ria 8,
 Taman Gembira, 58200 Kuala Lumpur.
 H/p No.: 011-5698 8328 (Whatsapps)
 Email: protrackland@outlook.com



All information contained herein is subject to change without prior notice as may be required by the relevant authorities and shall not form part of any offer or contract. Whilst every care has been taken in providing this information, the owner, developer, and managers cannot be held liable for any variations. All illustrations and pictures are for artistic impression only. The items are subject to variation, modification, and substitution as may be recommended by the relevant approving authorities. All plans and information contained herein are not final and shall be based on the approved building plans by the appropriate authorities.